

SYS

CORPORATION

專業創新·品質第一

RA series

多支裝空氣濾芯機

Multi-Cartridges Air Filter Housing

- ▶ O型環材質：EPDM / VITON / NBR / SILICONE / TEFLON+VITON
- ▶ 表面處理：內外拋光/內外拋光電解(EP)
- ▶ 材質：304/316/316L
- ▶ 設計壓力：10Kg/cm²
- ▶ 操作壓力：7Kg/cm²
- ▶ 設計溫度：100°C
- ▶ 操作溫度：75°C



FEATURES

- ▶ 專為中/大型體積氣流應用設計，可在低壓損之下提供高氣流並實現最佳節能效果
- ▶ 特製密合型扣座與杯型螺帽，拆卸安全方便，安裝成本及維護成本低，操作簡便
- ▶ 設計符合最高衛生等級標準，可滿足製藥、食品、飲料、無害氣體等相關產業
- ▶ 內外表面處理拋光至Ra 0.2μm，符合衛生等級要求，表面光亮如鏡面
- ▶ 吊耳設計，方便更換濾芯



RA series

多支裝空氣濾芯機

Multi-Cartridges Air Filter Housing

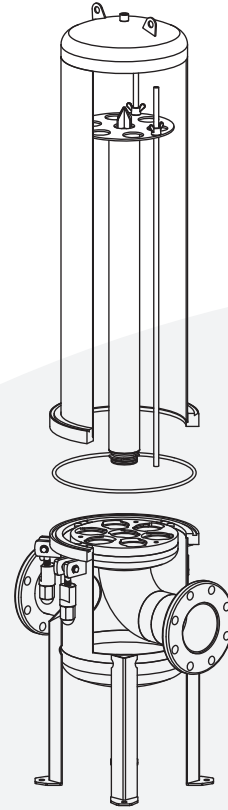
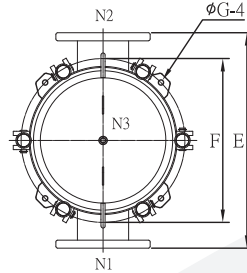
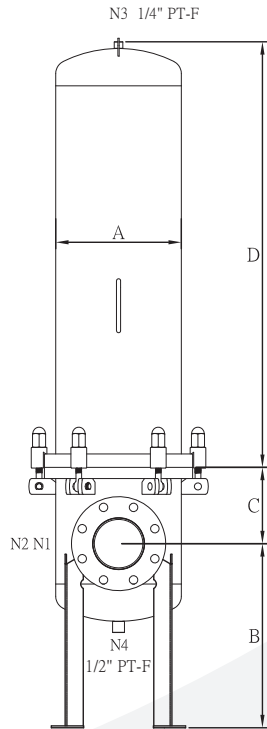

SPECIFICATIONS

Model	Length of Cartridge	N1/N2	A m/m	B m/m	C m/m	D m/m	E m/m	F/(PCD) m/m	G m/m	(Air) M ³ /Hr	Weight
3~4RA	30"	4"	Ø238	400	170	920	438	Ø320	Ø12	36~48	60 kg
5~7RA	30"	4"	Ø280	400	170	948	480	Ø365	Ø12	60~84	70 kg
8~12RA	30"	4"	Ø406	400	200	966	606	Ø516	Ø14	96~144	95 kg
13~19RA	30"	5"	Ø486	450	315	981	686	Ø596	Ø14	156~228	120 kg
19~32RA	30"	6"	Ø560	450	370	996	760	Ø704	Ø18	240~384	190 kg

PURCHASE CODE

3RA	3	C5	6	100	10K	E	3	3
Product code	Length of Cartridge	Cartridge	Material	In&Outlet size	In&Outlet type	O-ring Material	Interior surface finished	Exterior surface finished
3~32	1-10"	CF-DOE	4-304	100-4"	10K-JIS	E-EPDM	3-Polishing	3-Polishing
	2-20"	C5-222+Fin	6-316	125-5"	150P-ANSI	V-Viton	4-Electrolyze& Polishing (EP)	4-Electrolyze& Polishing (EP)
	3-30"	C7-226	6L-316L	150-6"	PN10-DIN	N-NBR		
					J-Clamp	S-Silicone		
					PF-BSPT-F	TV-Teflon+Viton		
					BF-BSPF-F			
					NF-NPT-F			

► 濾芯僅供選購
Filter element for optional purchase.

► 濾芯支數可依需求訂製
Qty of filter cartridge element can be customized.